



APPLICATION

For mounting fiberglass acoustical panels with two-part clips.

DESCRIPTION

This installation method uses a wall-mounted hanger bar (Wall Bar) and an Impaling Z-Clip to wall mount fiberglass acoustical panels. Engaging the two-part clip requires $\frac{3}{4}$ " of space above each panel. Installation is as follows:

1. Lay out panel location on wall.
2. Note that a minimum $\frac{3}{4}$ " clearance at the panel top.
3. Impale the Impaling Z-Clips to the back of the panels matching the layout of the Z-Clips.
4. Measure the Z-Clip locations on the back of the panel and transfer to the wall or ceiling.
5. Lift panel so Impaling Z-Clips in the back of the panel are above the Wall Bars. Drop panel down until Z-Clips fully engage in Wall Bars.
6. This installation technique will leave a $\frac{3}{4}$ " reveal between the ceiling and the top of the panel.
7. Use the following guide to determine the number of clip locations required.

| Panel Size | Number of Z-Clip Locations |
|---------------|----------------------------|
| 16 SF or Less | 4 |
| 17 to 32 SF | 6 |
| 33 to 50 SF | 8 |

Note: Due to variations in fiberglass thickness, some shimming may be required to align the panel edges.

Acoustic Design Works
1309 Norplex Drive
La Crosse, WI 54601

Z-CLIP

ELEVATION

SIDE VIEW

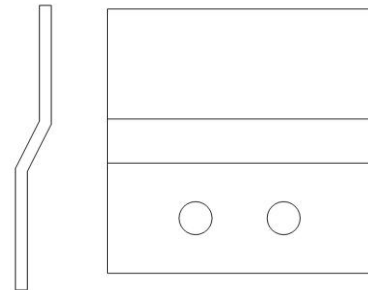

IMPALING Z-CLIP

ELEVATION

SIDE VIEW

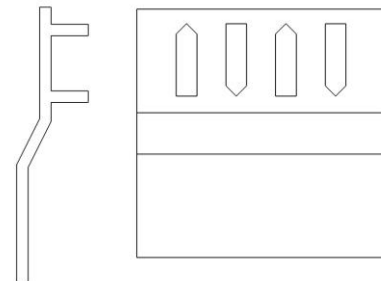

CROSS SECTION

